

**SMART RELAY PLUG****ITEM: SP2-10-1****ITEM DESCRIPTION: 10A SMART RELAY PLUG, SP2-10-1, (INBUILT RF MODULE GWF-KM26)****VERSION: V1.1****DATE: 2022-04-20****1. Product Instruction****1.1 Product Overview**

---

The smart plug should be used in conjunction with "Tata Power EZ HOME "APP, The device allows you to power on/off your home electronics appliances anytime and anywhere, making your home more secure and more convenient. You can schedule the smart plug to automatically power electronics on and off as needed, like setting lights to come on at dusk or turn off at sunrise. Amazon Echo lets you control devices connected to the smart plugs using just your voice.

**1.2 Product Appearance**

---

SP2-10-1 Smart Plug appearance:



### 1.3 Product Function

---

- High quality of Tactile Button switch, control electrical home appliance simply by pressing button
- Works with Amazon Alexa and the Google assistant, control your devices via voice.
- Advanced Wi-Fi access technology, users configure network one step intelligently by APP
- Control home appliances from anywhere by APP with Wi-Fi access (Local and Remote)
- Set schedule: Turn on/off your devices based on specific time you set
- Energy monitoring, view electricity usage during a period of time.
- Real-time power review
- Device interaction
- Multiple users control
- User-define scenes- Group control
- Overload feature
- Power On Switch status
- Control history view
- Support STA and AP work mode
- Support 2.4GHz Wi-Fi

### 1.4 Works with Alexa and the Google Assistant

---

The WiFi lighting switch works directly with Amazon Alexa and the Google Assistant, you can manage your devices through voice control like turn on/off. Assign a name to each WiFi lighting switch and communicate with each switch by name when making a voice command, Users could purchase these intelligent speakers on the market for convenient usage.



## 2. Product Specifications

### 2.1 Specifications

Parameters	Details
ON/OFF control	1 electrical socket
Data transmission	Wi-Fi 2.4GHz
RF Module	GWF-KM26
Wireless standard	802.11 b/g/n
Rated Voltage	180 ~ 240VAC
Rated Current	10A
Max output power	2200 W
Plug Output	Type D
Standard	India
Material	PC flame retarding
Fire Rating	UL 94
Shell Dimension	67.2*43.2*34mm
Operating Temperature	-20°C ~ +50°C
Operating Humidity	20%~85% (No condensing)
RF Range	30 meters indoor, 45 meters outdoors
APP Support	Support Android4.1 and iOS8.0 or above

## 3. Operation Instruction

### 3.1 Operation Instruction

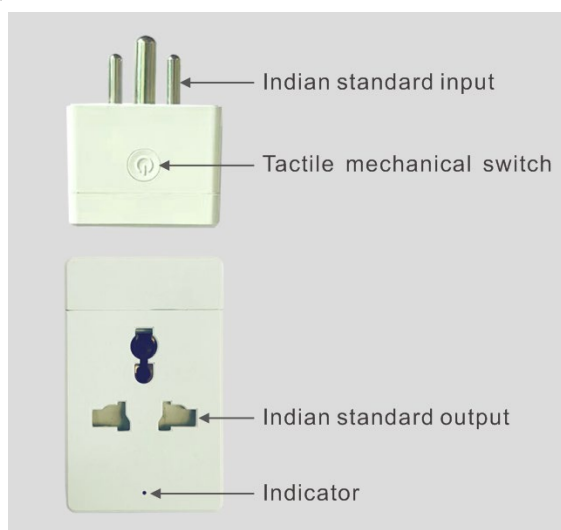

No.	Function	Details
1	Manual control button	1. Click the button to power on or power off 2. Restore factory settings: Press button 5 seconds till Wi-Fi indicator flashes fast.
2	Wi-Fi indicator (Blue)	1. Wi-Fi indicator keeps on stable when Wi-Fi connected successfully. 2. Wi-Fi indicator flashes when Wi-Fi connection failed or connected abnormal.
3	Power indicator (Red)	1. power indicator keeps on when switch power button ON the plug 2. power indicator is off when switch power button OFF the plug

### 3.2 APP Information

The APP is compatible with Android 4.1 and iOS8.0 or above system. iOS users could search the APP in App Store. Android users could search the APP in Google Play.

APP English name: "TATA Power EZ Home"



Tata Power EZ HOME

(QR code TATA Power EZ Home for both Play Store & App Store)

### 3.3 Wi-Fi Configuration

Once the WiFi connection is successful, the device will work in two work modes.

Work Mode	WiFi Control	Direct Control
APP local control	Yes	Yes
APP remote control	Yes	N/A
Alexa/The Google Assistant	Yes	N/A

\*After connection successfully, users could set work mode in APP

### 3.3.1 Add device in Easy Mode

Wi-Fi networking configuration for smart plug is convenient and rapid, mobile could be connected to the designated router quickly, the whole process is generally less than 15 seconds.

Make sure smart plug is powered on. (The Smart Plug only supports 2.4GHz Wi-Fi router)

Configuration process:

Step 1, power on the plug, search in App store/Google Play or scan QR code to install APP, connect mobile phone to 2.4GHz Wi-Fi. Step 2, open APP to click “+” to select device, select “Smart Plug”.

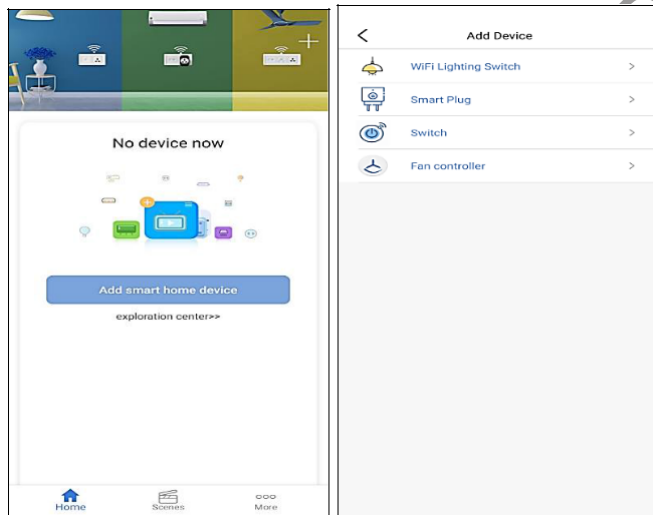

Step 3, In the new page, select the a preferred WiFi network, enter the WiFi password, click “Configure signal”.

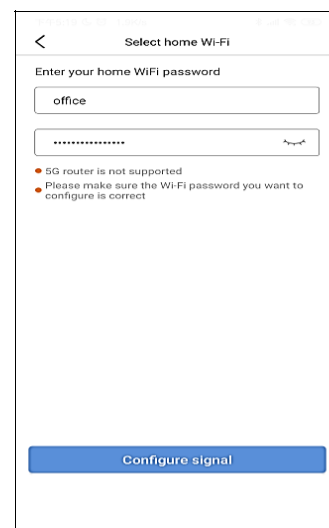

Step 4, once the plug is powered on, If blue indicator flashes quickly, please confirm directly. If not, please reset device: long press ON/OFF button 5 seconds until blue indicator flashes quickly. If yes, please confirm and process next step “Blue indicator is flashing”.

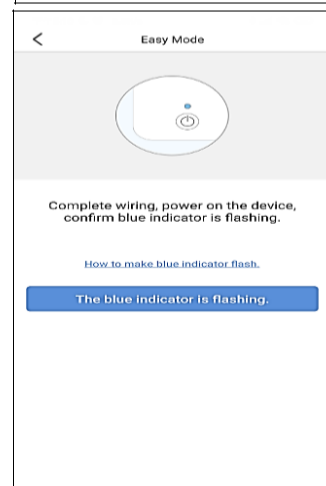

Step 5. Configuration of Smart Plug is in progress”.

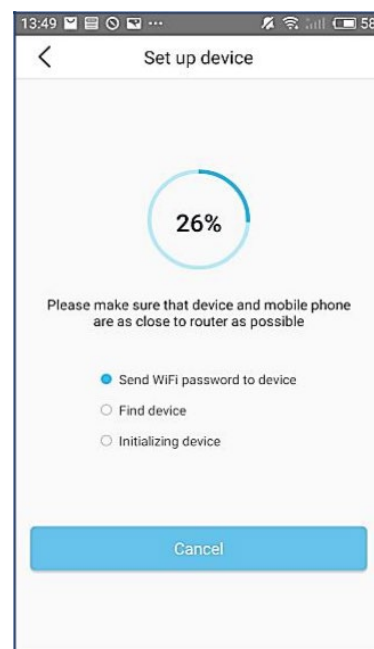

### 3.3.2 Add device in AP Mode

*Remark: This configuration is a supplementary configuration way, if you failed configuration in Easy mode, please try AP mode to add device.*

Step1. If the configuration in easy mode failed, you will find following page, Click “Add device by AP mode” button to add device. Please confirm the blue indicator starts flashing slowly before that.

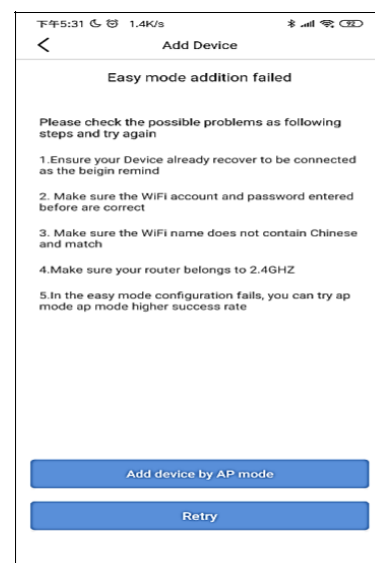

Step2. According to page prompt, go to WLAN setting in your smart phone and click to “Connect to device Wi-Fi” and then select the “TAPlug\_XXXX (last 4 characters are 4 digit numerical Device Id number)”, no need to input password.



Step3. Once you select the “TAPlug\_XXXX”, go back to app, click ▼ to select Wi-Fi and input password, click “Next Step” to start connection. Once devices configured successfully, you will find it in device list.

**Remark:**

1. If there is no Wi-Fi around Smart Plug, you can click ▼ select “direct control”, and the Smart plug will work in direct mode, in this mode, APP can only local control for the Smart plug.

2. if the device needs to be voice controlled by Alexa/the Google assistant or remote controlled by APP. The device must be added in Wi-Fi control work mode.

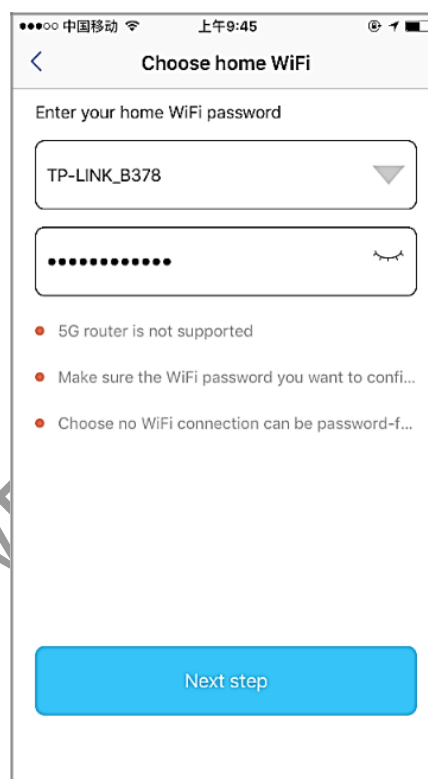

### 3.3.3 Shortcut Configuration

If the device has been configured and work in Wi-Fi control mode, users who want to control the plug just connect the mobile to Wi-Fi, the device connected, then open the APP, click “+” then enter to click orange prompt message to add device, after configuration, users can local control and remote control the plug. Subject to “Share Device” mode enabled for Smart Plug.

Remark:

1. Only administrator can turn on sharing mode, administrator is the first user account who connected smart switch.
2. Sharing mode is enabled for default, if the administrator close the sharing mode in setting, the users can't find device via this configuration.
3. Sharing mode only work in Wi-Fi control work mode, sharing mode focus on account in the same Wi-Fi, if administrative open sharing mode, other users also could search smart plug in the same Wi-Fi without restoring factory settings.

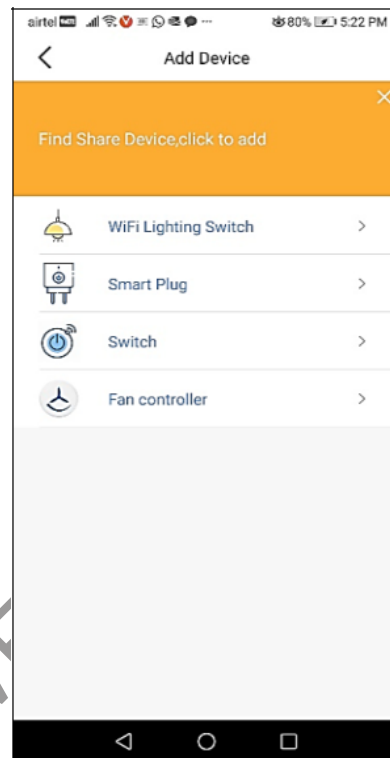

### 3.3.4 Share Configuration

---

If the device has been added successfully and work in Wi-Fi control work mode, administrator can share the device to users to help their configure device, the users who configure plug just need to keep mobile in same Wi-Fi/4G network.

Remark:

1. Only administrator could share device with other account
2. The users who is shared with Smart plug will receive prompt message in APP but do not have permission to share others again.
3. The user who is shared with modular smart Wi-Fi switch could local



or remote control the smart light.

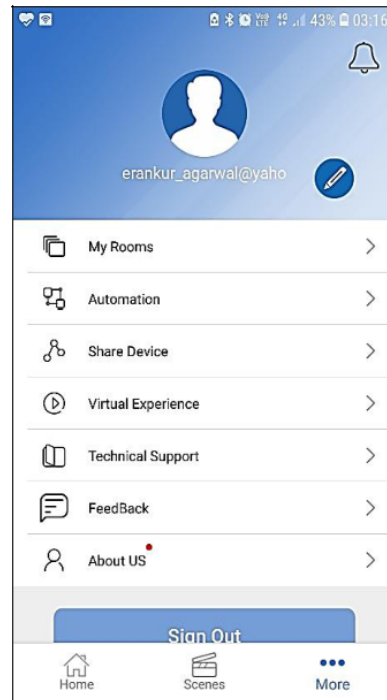

### 3.4 Wi-Fi Work Mode

Smart plug Wi-Fi work mode is Wi-Fi control/Direct control. If there is Wi-Fi network in the usage scenario, the smart plug supports two work mode.

Wi-Fi control work mode: connect mobile phone to home Wi-Fi router firstly, users need to input correct Wi-Fi password in “Tata Power EZ HOME” APP, when the device receive the router broadcast, it connect to network automatically, which support local control and remote control. Smart plug works in Wi-Fi control work mode for default. In this work mode, there must be good Wi-Fi network coverage around the smart plug; mobile phone can connect to Wi-Fi or 4G.

Direct control work mode: when there is no Wi-Fi around the smart plug, mobile phone is connected to smart plug Wi-Fi directly. Mobile phone connects to the smart plug signal “TAPlug\_XXXX”, then choose “direct control” in networking page.

#### **4. Disclaimer**

---

This specification is a detailed description of series products produced by the company, please read carefully and fully understand the detailed specification parameters of the product.

All rights reserved by company, without permission of our company, the company do not allow to totally or partly copy, translate or simplify this specification for any other usage.

We do not provide any guarantees for the product information, parameters, photos or other links in the specification, users bear the risks.

We declare that this specification or other relevant information without any implied warranties of business assurance or business contract assurance. All information inside is only for operation, product user manual or reference, it can't be regarded as a basis or complement for any other contract.

We have made reasonable efforts to make this document content accurate and up-to-date.

but our company reserves the right to update or revise the content and its related information at any time without additional notice.

THE TATA POWER COMPANY LIMITED